

SECTION A-A

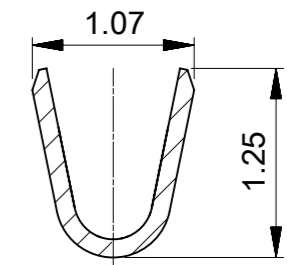

SECTION B-B

NOTES:

- 適合ハウジング: 501330****
APPLICABLE 501939****
HOUSING
- めっき仕様: 表題欄参照
PLATING:SEE TABLE
- 圧着条件については、
圧着仕様書(CS-501193-001)を参照願います。
PLEASE REFER TO CRIMP SPECIFICATION (CS-501193-001).
- 製品の取扱いについては、コネクタ取扱い
説明書(5013300000 PS A00,A01)を参照願います。
PLEASE REFER TO INSTRUCTION MANUAL (5013300000 PS A00,A01).

金型番号(番号無しの製品もあります)
DIE NO.(THERE IS NON-MARK ITEMS)

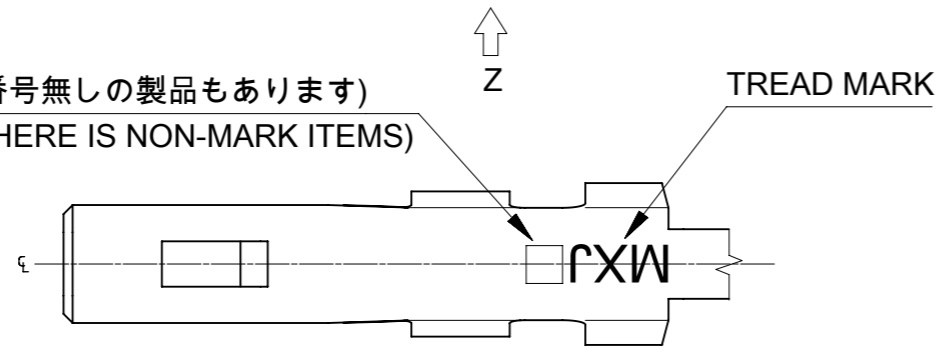

VIEW Z

1.0 μ m MIN.	5013340100	バラ状 LOOSE
	5013340000	連鎖状 CHAIN
めっき仕様:すずめっき (リフロー処理,前めっき) PLATING:TIN PLATING (REFLOW TREATMENT,PRE-PLATED)	オーダー番号 ODER NO.	端子形状 FORM

MATERIAL りん青銅 すずめっき PHOSPHOR BRONZE t=0.12 TIN PLATING	THIS DRAWING CONTAINS INFORMATION THAT IS PROPRIETARY TO MOLEX ELECTRONIC TECHNOLOGIES, LLC AND SHOULD NOT BE USED WITHOUT WRITTEN PERMISSION									
	DIMENSION UNITS mm	SCALE 20:1				CURRENT REV DESC: REDRAWN AND REVISED				
	FINISH SEE NOTE	GENERAL TOLERANCES (UNLESS SPECIFIED)	EC NO: 178320			PICO-CLASP 1.0 W/B CONN CRIMP REC TERM (TIN PLATING)				
	WIRE RANGE AWG#28-32	ANGULAR TOL $\pm 3.0^\circ$	4 PLACES ± 0.2	DRWN: MOYAMA 2018/06/21	CHK'D: SAKIYAMA 2018/06/22					
INS. RANGE $\varnothing 0.4-0.8$	DRAFT WHERE APPLICABLE MUST REMAIN WITHIN DIMENSIONS	3 PLACES ± 0.2	2 PLACES ± 0.2	1 PLACE ± 0.2	0 PLACES ± 0.2	APPR: TKANEKO 2018/06/22 INITIAL REVISION: DRWN: KYAMADA02 2017/10/05 APPR: TKANEKO 2018/06/21	PRODUCT CUSTOMER DRAWING DOCUMENT NUMBER 5013340000-SD	DOC TYPE PSD	DOC PART 000	REVISION B
DOCUMENT STATUS P1	RELEASE DATE 2018/06/22 08:13:47	THIRD ANGLE PROJECTION 	DRAWING A3-SIZE	SERIES 501334	MATERIAL NUMBER SEE TABLE	CUSTOMER	SHEET NUMBER 1 OF 1			